

The information contained in this drawing is the sole property of Coil Winding Specialist.
Any reproduction in part or whole without written permission of Coil Winding Specialist is prohibited.

DIMENSIONAL TOLERANCE INCHES [MM]					
A(OD)	B (WIDTH)	C(LEAD)	D(LEAD DIA)	P1 REF	P2 REF
MAX	MAX	MIN	MIN		
1.32" [33.50]	0.73" [18.50]	0.50" [12.70]	0.05" [1.15]	0.31" [7.80]	1.01" [25.60]

REVISION HISTORY				SIGN & DATE	
REV	ECN	DESCRIPTION		BY	DATE
B	N/A	ELEC. AND MECH. UPDATED	OK	3/20/11	3/20/11
C	N/A	ELEC. AND MECH. UPDATED	OK	9/14/12	9/14/12
D	160208	REVISE ELECTRICAL AND DIMENSIONS	AK	02/08/16	02/08/16
D1	160208	REVISE DESCRIPTION	LL	07/07/17	07/07/17



SCHEMATIC

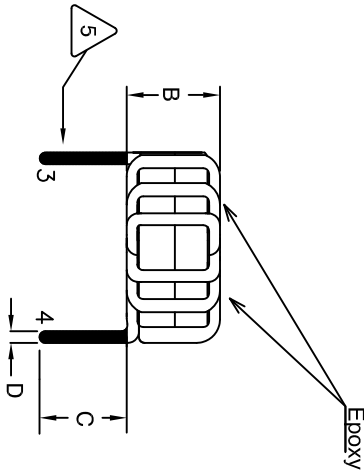

FRONT VIEW

- 7 BUILT TO RoHS COMPLIANCE
- 6 MARK PART NUMBER AND REVISION IF APPLICABLE.
- WITH COIL EDGE.
TRIM LEADS APPROX. 0.5 INCH AND FLUSH
APPLY EPOXY TO SPACER WHERE SHOWN.
REMOVE WIRE INSULATION AND TIN.
- 5 WIND COILS EVENLY SPACED
- 4 CONSTRUCTION:

WEIGHT = 36 GRAMS
MAX TEMP RISE = 40°C
OPERATING RANGE : -25° TO 120°C
INTER WINDING ISOLATION = 2000 VOLTS RMS, 3mA, 2 sec.
INTERWINDING CAPACITANCE = 6.60 pF TYP @ SRF
IMPEDANCE = 7.0 kΩ TYP @ SRF
SRF = 1.20 MHz TYPICAL
LEAKAGE INDUCTANCE = 9.0 μH TYP @ 10kHz, 1Vrms
INDUCTANCE = 14.0 mH MIN @ 1 kHz, 1 Vrms, 0 Amps
DCR ON EACH WINDING = 13.0 mΩ MAX
MAX VOLTAGE ACROSS TERMINALS 1-2 OR 3-4 = 250 VAC OR VDC
RATED CURRENT = 10.0 AMPS
INSULATION RESISTANCE = 100 MEGA-OHMS MIN @ 500 VDC
SPECIFICATIONS @ 25°C

- 3 WIRE: UL CLASS 200°C WIRE
CWS BYTEMARK OR OTHER APPROVED PART
CORE: NANO CRYSTALLINE OR AMORPHOUS CORE
- 2 CASE = UL CLASS B (130°) RATING
- 1 MATERIAL: UL RECOGNIZED

NOTES: UNLESS OTHERWISE SPECIFIED. READ FROM BOTTOM UP.

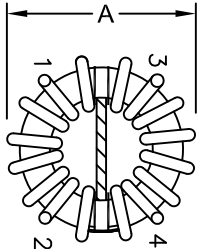

BOTTOM VIEW

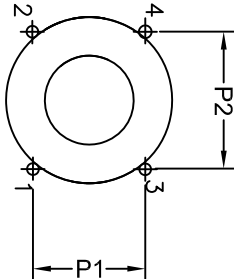

FOOTPRINT

PARTS LIST			
AUTOCAD	X	www.coilws.com, inc	CWS Coil Winding Specialist.
SOLIDWORKS		353 WEST GROVE AVE	
SIGN	DATE	sales@coilws.com	ORANGE, CA 92865 (CAGE: 50ME2)
DATE	12/16/10	TITLE:	Nanocrystalline Inductor
BY/IN	RLAU	COMMON MODE CHOKE	
CHKD	AK	Horizontal Mount	CAGE# 5DME2
DATE	12/16/10	SIZE	1000±0.05
APPR	LLAU	ANGLE PROJECTION	45°±30°
DATE	03/30/11	SCALE	N/A
DO NOT SCALE DRAWING		SHEET 1 OF	1